

Instructions for wear checks of play equipment	The equipment must be checked and maintained at the following control points for correct operation and safety:	Proof of maintenance
<p>Location</p> <p>Date of installation</p> <p>Checks depend on the type of equipment. Any equipment with moving parts must be checked at least twice a year, static equipment at least once a year.</p> <p>Intervals for maintenance work and checks generally depend on</p> <ul style="list-style-type: none"> - location - kind of use - frequency of use - possible vandalism <p>Repairs only by qualified personnel</p> <p>Whirlpool Column Order No. 10.17000/10.17500</p> <p>*) If temperature falls below 15 °C, observe ice formation and take equipment out of action if necessary. Otherwise the drive become damaged.</p> <p>If necessary, the crank can be removed temporarily using a puller.</p> <p>The whirlpool column is a piece of equipment with an inner mechanism. Wear parts must be replaced when their service life has expired.</p> <p>We are pleased to carry out customer service.</p>  <p>For spare parts refer to back of page.</p>	<p>Mechanism</p> <ol style="list-style-type: none"> 1. Check the crank drive, left for functionality and right for free wheel. 2. Check that the handle turns easily on its bolts and is sitting straight (without touching). 3. A visual inspection can be carried out on the internal mechanism above the opening (separate document available). Maintenance with Ballistol oil. Oil free wheel (squeaking noise). Do not alter the workshop calibration. <p>Filling</p> <ol style="list-style-type: none"> 4. Check the water level: approx. 50 - 70 cm clearance above the water column in static condition is correct. 5. Check liquid for clarity, (Caution! Do not add any foreign material or colourings). 6. At minus temperatures the equipment is fully functional up to minus 15 degrees *), from 25 degrees the column can freeze. 7. The water filling is durable for many years and does not need to be changed. <p>Stainless steel</p> <ol style="list-style-type: none"> 8. Clean with stainless steel spray (www.kimtec.de) using a clean cloth. <p>Acrylic glass</p> <ol style="list-style-type: none"> 9. Clean with commercially available dishwashing liquid or, better still, plastic cleaner (www.burnus.de), under no circumstances use spirits or turpentine! (see page 3) <p>Structural stability</p> <ol style="list-style-type: none"> 10. Check anchoring to the ground every 12 months. <p>Repair not carried out, it is still possible to play on equipment</p> <p>Repair not carried out, equipment is taken out of action</p> <p>All work carried out, everything is in order</p> <p>Maintenance carried out by:</p> <p>Date</p>	<p>Special notes, e.g. for repairs</p>

Spare Parts

Whirlpool Column

Order No. 10.17000

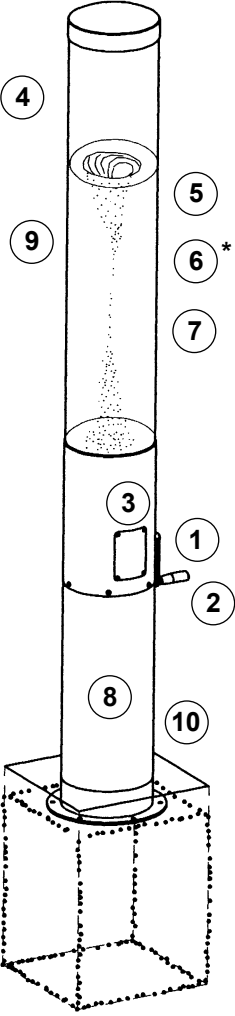

Please note that the safety standards of the equipment must not be affected. Therefore, when carrying out repairs it is helpful to **only use original parts**.

Order No.	Spare part
10.99901	20 litre canister of water with antifreeze (three canisters are necessary per water column)
10.99902	cylinder
10.99911 10.99930	timing belt, width 20 mm timing belt, width 30 mm
10.99918	crank complete
10.99924	handle
10.99926	drain sleeve
10.99941	gear

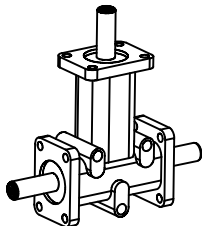
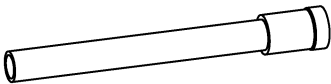
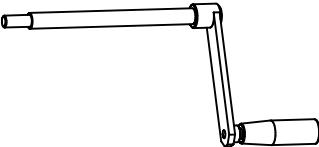
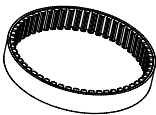

Care instructions for acrylic glass tube

Always carry out preliminary cleaning using plenty of water with a drop of dishwashing liquid added. Never wipe away dust with a dry cloth; cloths must always be freshly washed.

Preliminary cleaning with thinner must be carried out in cases of heavy soiling e.g. graffiti or similar. When cleaning put as little as possible on a cotton cloth, the paint should be diluted in circular movements. When re-soaking always use a clean part of the cloth.

Alternatively a special glass cleaner can be used. This thinner should likewise be applied carefully and economically so that no cracks form.

Car polish has proved itself as a good sealing agent. Follow the instructions for the polish.

Manufacturers of care products, e.g. www.sonax.de or www.burnus.de

Richter Spielgeräte GmbH

INFORMATION SHEET for customers

Last updated: Aug. 01 2007

applies to: liquid contained in Whirlpool Column and Water Prism

NAME OF HAZARDOUS MATERIAL**Special anti-freeze liquid (contains 25 % glycol)****HAZARDS TO HUMAN HEALTH AND THE ENVIRONMENT**

Harmful if swallowed.

Details

hygroscopic
incompatible with various synthetic materials

Hazards to the environment: slightly hazardous to water (WGK 1, according to German water hazard class system)**SAFETY MEASURES AND HANDLING**

Keep containers always closed. Do not spill or splash liquid when decanting or filling. Materials that can react must be kept away or added in a controlled manner.

Avoid spraying.

Do not eat, drink, smoke or breathe in through your nose. Avoid inhaling vapors or mists. Avoid eye and skin contact. Thoroughly clean hands and other contaminated parts of the body at the end of the working day and before every break. Use skin care products. Store leisure clothes separate from work clothes!

**Pay attention to work restrictions!****Eye protection:** Wear safety glasses with side protection.**Hand protection:** Wear gloves made of nitrile rubber. Coating thickness 0.11 mm. Breakthrough time: >480 min.**Body protection:** During filling: Wear protective apron!**ACCIDENTAL RELEASE MEASURES**

Always wear protective glasses and gloves when cleaning up leaks or spills. Pick up and dispose of liquid using absorbent, noncombustible material (e. g. diatomaceous earth, sand)! Thoroughly ventilate the room afterwards.

FIRST AID MEASURES

General advice for first aid measures: Protect yourself. Provide basic life saving measures such as "recovery position" (lateral recumbent position), "cardiopulmonary resuscitation", "shock treatment" depending on the situation. Cover wounds with sterile dressing. Provide for physical rest and protect against thermal loss. Consult a doctor (eye specialist if necessary).

Eye exposure: while protecting the unhurt eye immediately and thoroughly rinse the other one using water (approx. 10 minutes) with eye lid open. In case of eye injury apply sterile bandage. After eye contact, ophthalmological treatment is mandatory.

Skin exposure: Immediately take off clothes, including underwear and shoes. Rinse skin with large amount of water.

Inhalation: Remove injured person from exposure, always ensuring self-protection. If breathing is difficult, have injured inhale oxygen. In case of apnea, artificial respiration is necessary: use respiratory appliances.

Ingestion: Immediately rinse mouth thoroughly.

DISPOSAL CONSIDERATIONS

Do not dispose into sink or garbage can! Collect waste separately.

Product: Keep containers. Drain into designated containers only. For disposal, return containers to Richter Spielgeräte GmbH, Simsseestr. 29, 83112 Frasdorf, Germany. Disposal is free of charge.