

The equipment must be checked for correct operation and safety, especially the points listed below:

Proof of maintenance

Wooden parts

1. Check for rot and, if necessary, smooth out splinters and round off sharp edges of cracks.
2. Check that all bolts and screws are tight and retighten if necessary.
3. If required, touch up or renew the paint-work using a solvent-free acrylic paint.
4. **Recommendation:** apply paraffin wax to the upper end grain areas once a year, please refer to Order No. 0.90100. 1 litre.

Slide

5. Check for vandalism.
6. Check bolts and screws on the base equipment are tight and retighten if necessary.
7. Check the starting section bar for stability.

- ## Structural stability

8. In order to check for corrosion, uncover the foundations once a year.

Order No. 4.08301 and Staircase
Order No. 4.08304 and Ramp

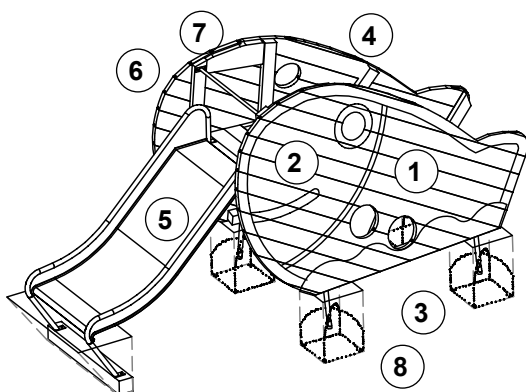

Repair not carried out, it is still possible to play on equipment

**Repair not carried out,
equipment is taken out of action**

**All work carried out,
everything is in order**

Maintenance carried out by:

..... **Date**

Special notes, e.g. for repairs